



Important Safeguards

This appliance is not intended for use by children or infirm persons without supervision. Young children should be supervised to ensure that they do not play with the appliance.

Warning: To guard against injury, basic safety precautions should be observed, including the following:

1. Read and follow all safety instructions before using this appliance.

2. Danger: To avoid possible electric shocks, special care should be taken since water is employed in the use of aquarium equipment. For each of the following situations do not attempt repairs yourself. Return the appliance to an authorised service facility for service or discard the appliance.

a) If an appliance falls into water, do not reach for it, unplug it and then retrieve it. If the electrical components of the appliance get wet, unplug the appliance immediately (non immersible equipment only).

b) If the aquarium shows any sign of abnormal water leakage, immediately unplug all accessories from the power source.

c) Carefully examine the power head after installation. It should not be plugged in when there is water on parts which are not intended to be wet.

d) Do not operate any aquarium accessory if it has a damaged cord or plug, or if it is malfunctioning, or dropped or damaged in any manner.

A "drip loop" (See the diagram) should be arranged by the user for each cord connecting an aquarium component to a receptacle. The drip loop is the part of the cord below the level of the receptacle or the connector if an extension cord is used. It is used to prevent water traveling along the cord and coming in contact with the receptacle.

If the plug or receptacle does get wet, do not unplug the appliance. Disconnect the fuse or circuit breaker that supplies the power to the appliance, then unplug and examine for presence of water in the receptacle.

3. Close supervision is necessary when the appliance is used by or near children.

4. Always unplug the power head from the electrical outlet, when not in use, before putting on or taking off parts, before any type of maintenance,

or cleaning. Never yank the cord to pull it from the outlet. Grasp the plug and unplug to disconnect.

5. Do not use the power head for reasons other than the intended use. The use of attachments that are not recommended or sold by the power head manufacturer may cause the product to be unsafe. This is not recommended.

6. Do not install or store the power head where it will be exposed to weather or temperatures below freezing.

7. Make sure any component mounted on a tank is securely installed before operating it.

8. Read and observe all the important notices on the pump.

9. Ensure input voltage is the same voltage as your local power supply.

10. If an extension cord is necessary, a cord with a proper rating should be used. Care should be taken to arrange the cord so that it will not be tripped or pulled.

11. A **G.F.C.I** (Ground fault circuit interrupter) & surge protector is recommended for all electrical appliances.

12. Ensure your hand is dry when turning the power switch on/off and when inserting/removing the power cord from the receptacle.

13. If you are in any doubt about the electrical installation or safety of this product you must consult a qualified electrician.

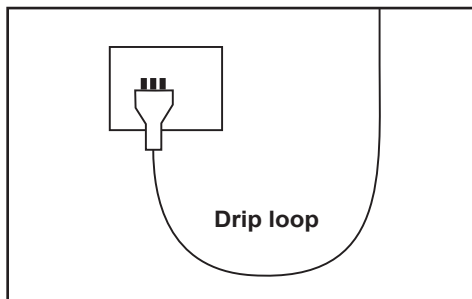

For Guarantee Conditions, please refer to the Guarantee form at the back of this instruction booklet.

Important Safeguards

Connecting your appliance to the mains electricity supply - Country specific instructions.

United Kingdom

The plug supplied with this product is a sealed plug and we do not recommend removing or changing it. However, should the need arise, only a suitable plug should be connected using the following diagram 1

An approved earth leakage circuit breaker (RCCB) or otherwise known as an Residual circuit current device (RCCD) must be also fitted in the supply line.

IF YOU ARE IN ANY DOUBT ABOUT INSTALLING YOUR APPLIANCE YOU SHOULD CONSULT A QUALIFIED ELECTRICIAN.

Australia, New Zealand and Hong Kong

In Australia, New Zealand and Hong Kong all products are supplied with fitted plugs. This plug should **NOT** be tampered with in any way or removed. Removal or tampering with the plug invalidates our guarantee offered with this product.

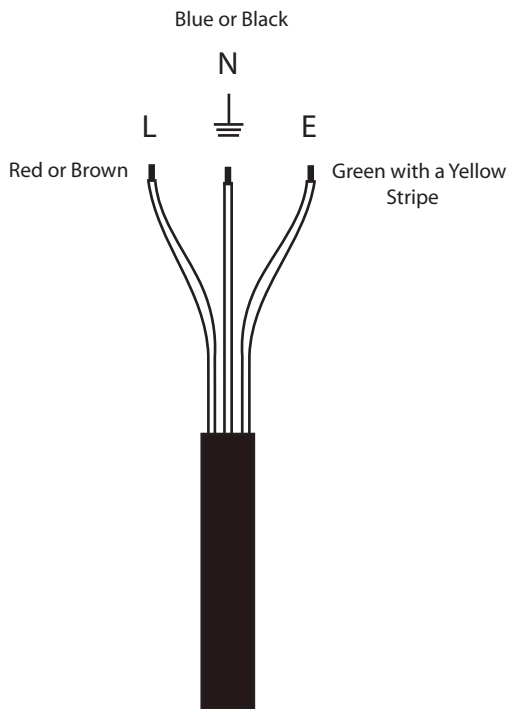

Diagram 1

Before First Use / Preparation

Read and follow all the instructions, even if you feel you are familiar with the product and find a place to keep the instructions handy for future reference. Your attention is drawn particularly to the sections concerning **“IMPORTANT SAFEGUARDS”** and the **“GUARANTEE CONDITIONS”**. Please ensure you retain your original purchase receipt in the event that guarantee service is required.

Carefully unpack the power head making sure you keep all the packing material until all the parts of the product have been found and the product has been assembled.

This product is shipped to you in a factory sealed carton. Should the product malfunction in any way or if the unit is damaged and requires replacement, contact the retailer where the product was purchased for inspection.

Correct Positioning In Aquarium

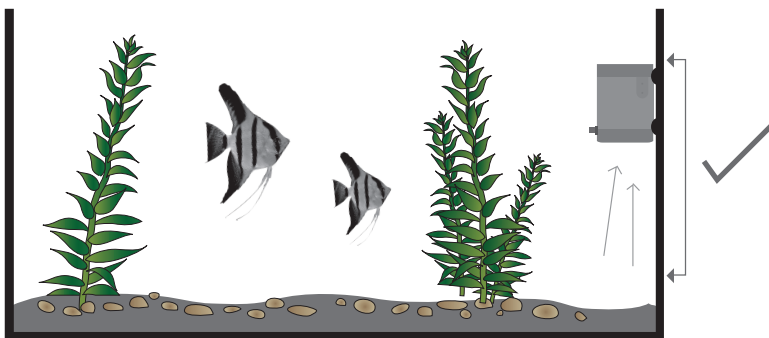

Set the power head up within the arrows indicated above.

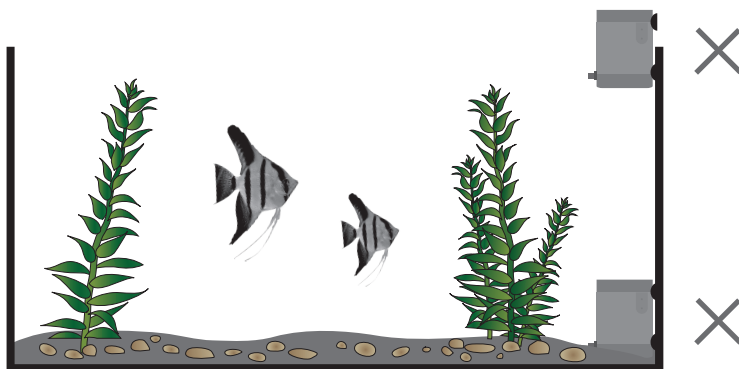

The power head must not be out of the water and must not be in contact with any substrate.

Know Your Power Head 300 - LV

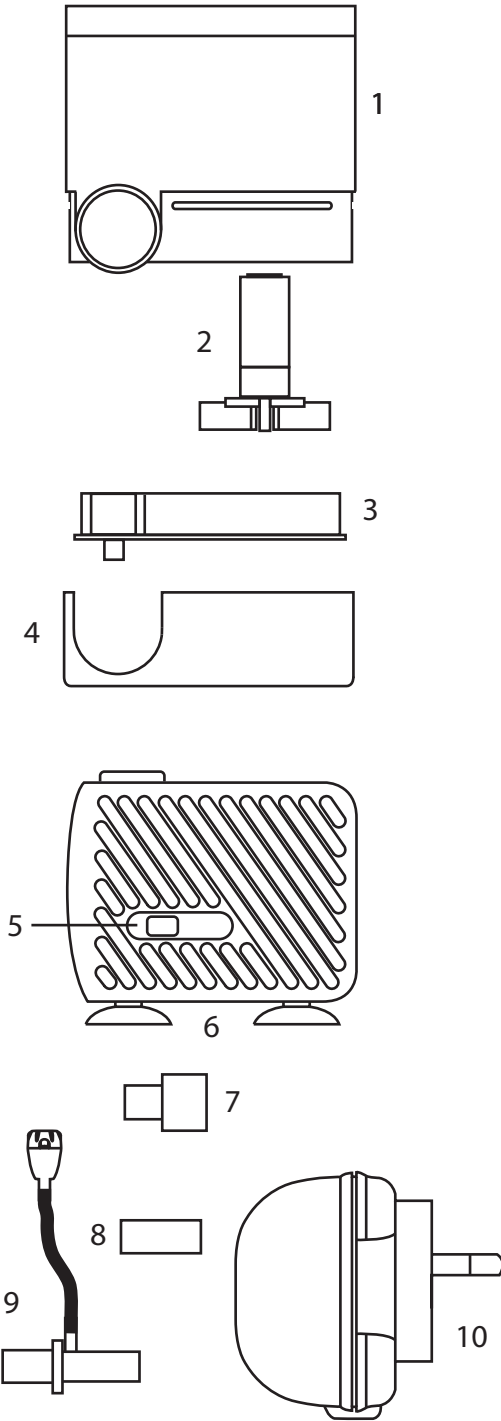

1. Motor
2. Impeller
3. Impeller Cover
4. Pre Filter
5. Flow Controller
6. Suction Cups
7. 13mm Outlet
8. 9mm Outlet
9. Venturi Outlet With Venturi & Air Line
10. Transformer

Replacement Parts & Filter Media

Use Aqua One Genuine Spare Parts Only. See your local Aqua One Dealer and look for the number listed below for the spare part you require. Alternatively you will find these numbers on the silver label located on the product.

300 Mini Power Head Impeller 34I

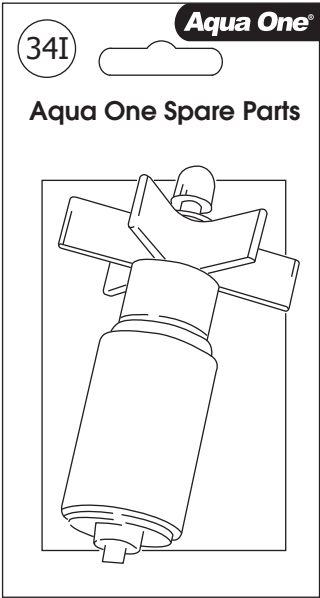

Know Your Power Head 301 - LV

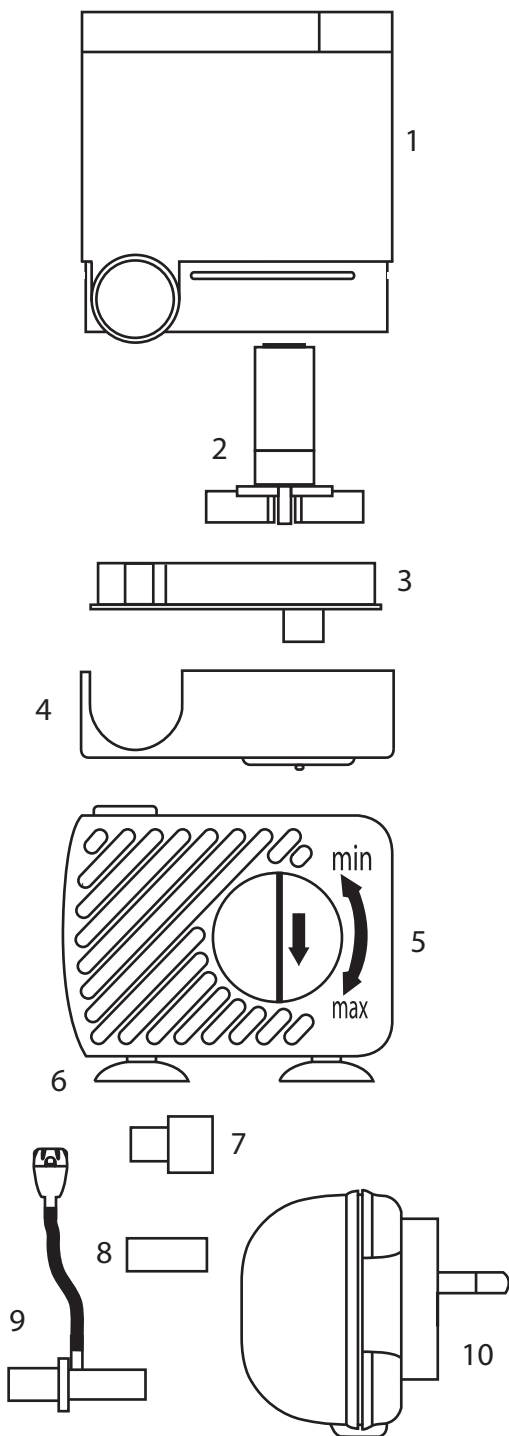

1. Motor
2. Impeller
3. Impeller Cover
4. Pre Filter
5. Flow Controller
6. Suction Cups
7. 13mm Outlet
8. 9mm Outlet
9. Venturi Outlet With Venturi & Air Line
10. Transformer

Replacement Parts & Filter Media

Use Aqua One Genuine Spare Parts Only. See your local Aqua One Dealer and look for the number listed below for the spare part you require. Alternatively you will find these numbers on the silver label located on the product.

301 Mini Power Head Impeller

35I

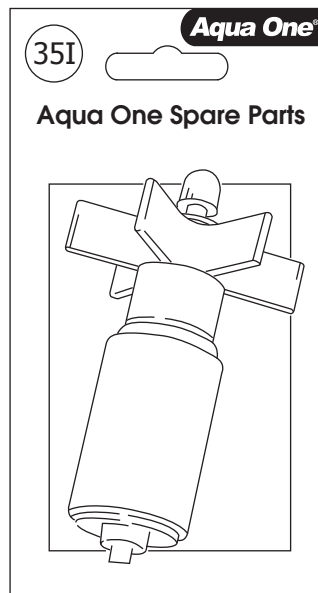

Know Your Power Head 302 - LV /302 - ML

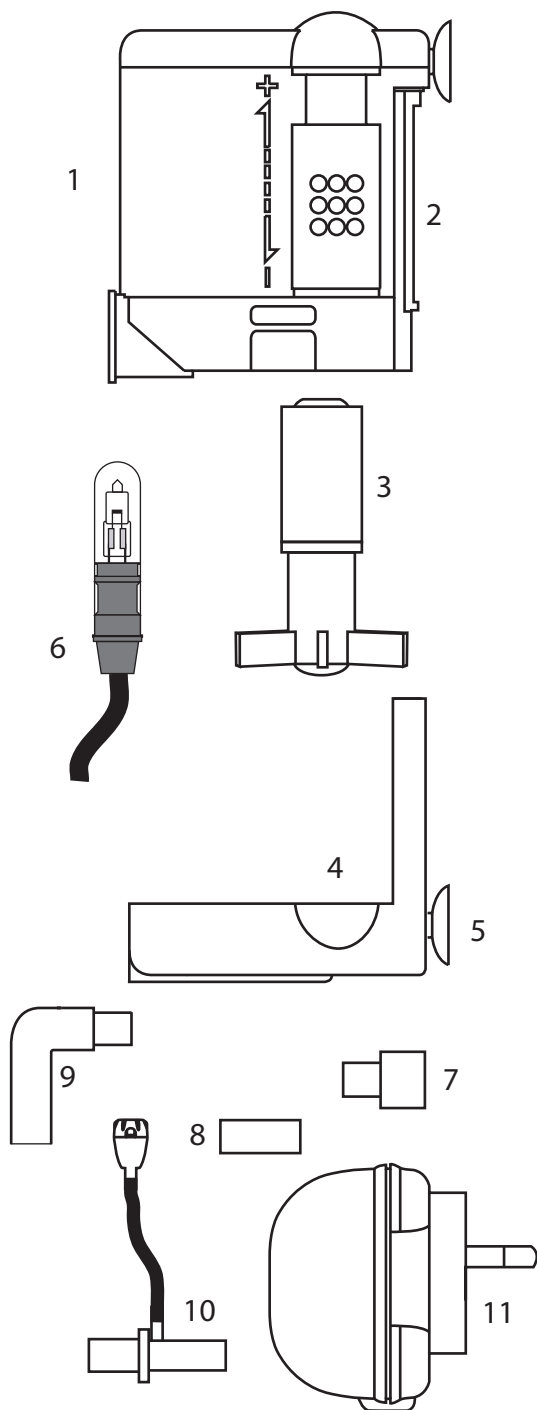

1. Motor
2. Flow Controller
3. Impeller
4. Mounting Bracket/Pre Filter
5. Suction Cups
6. Light 5W 12V (302-ML)
7. 13mm Outlet
8. 9mm Outlet
9. Elbow
10. Venturi Outlet With Venturi & Air Line
11. Transformer

Replacement Parts & Filter Media

Use Aqua One Genuine Spare Parts Only. See your local Aqua One Dealer and look for the number listed below for the spare part you require. Alternatively you will find these numbers on the silver label located on the product.

302 Mini Power Head Impeller 36I

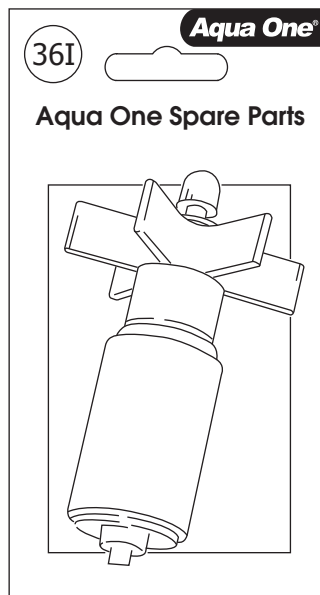

Installation 300/301-LV

Aqua One 300 series power heads are low voltage, the transformer is located on the plug. They come fully assembled and ready to use.

1. Decide on which outlet option to use.

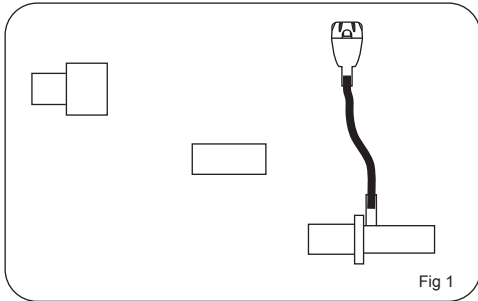

- a) If no attachment is required simply install the power head as is, or push one of the other outlets into power head.

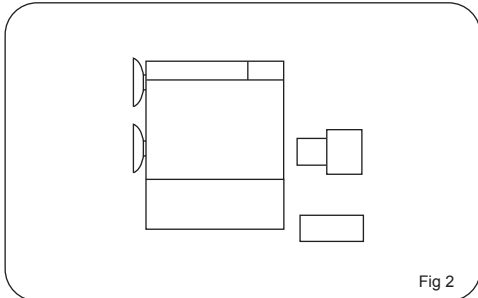

- b) If the venturi is required, push venturi outlet directly into pump outlet and hang the airline outside the aquarium.

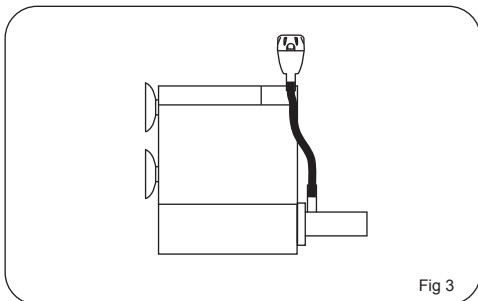

2. Suction cups will fasten the filter to the wall of your aquarium. It is best to have surface agitation.

3. Use flow adjuster on the bottom of the power head:

max: will allow full flow

min: will reduce the flow

Remember the more flow the better.

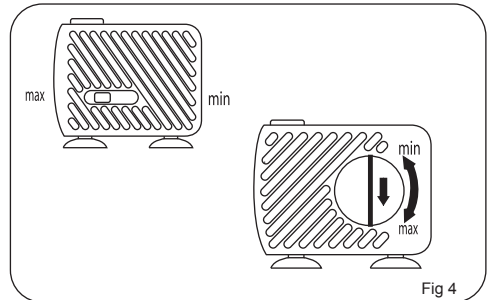

Maintenance 300/301 Power Head

Clean the impeller at least once a month. Refer to the "Know Your Filter" page for help with the following procedure.

1. Remove the power head from the aquarium and take it to the sink.

2. Grasp the motor with one hand and pre filter with the other and gently pull apart.

3. Remove the impeller cover to gain access to the impeller.

4. Pull impeller from the motor and rinse properly. Use an *Aqua One* double ended pipe brush to clean the impeller and the impeller well and also any of the outlet options that are being used.

5. Put the power head back together and return to the aquarium. Ensure your hand is not wet, plug in at the power supply and turn on.

Installation 302-LV / 302-ML

Aqua One 300 series power heads are low voltage, the transformer is located on the plug. They come fully assembled and ready to use.

1. Decide on which outlet option to use.

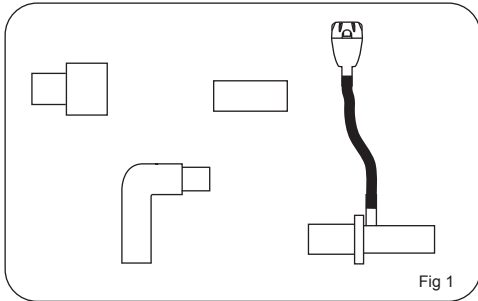

Fig 1

- a) If no attachment is required simply install the power head as is, or push one of the other outlets into power head.

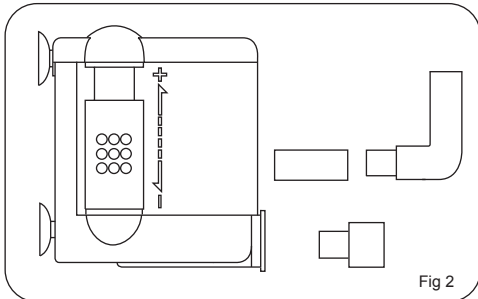

Fig 2

- b) If the venturi is required, push venturi outlet directly into pump outlet and hang the airline outside the aquarium.

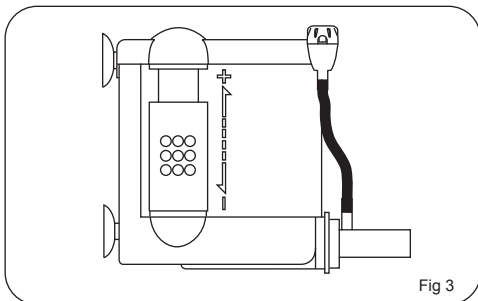

Fig 3

2. Suction cups will fasten the filter to the wall of your aquarium. It is best to have surface agitation.

3. Use flow adjuster on the bottom of the power head:

+ will allow full flow
- will reduce the flow

Remember the more flow the better.

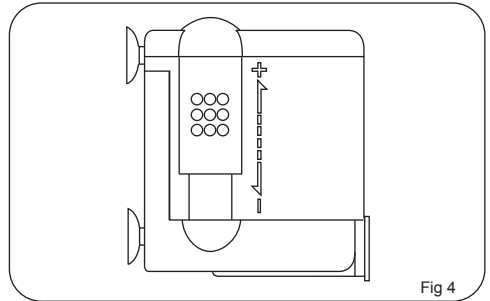

Fig 4

4. The light which is supplied with the 302-ML is a water proof unit and may be placed anywhere in the aquarium or water feature.

Maintenance 302-LV / 302-ML

Clean the impeller at least once a month. Refer to the "Know Your Filter" page for help with the following procedure.

1. Remove the power head from the aquarium and take it to the sink.

2. Grasp the motor with one hand and pre filter/mounting bracket with the other and gently pull apart.

3. Remove the impeller cover to gain access to the impeller.

4. Pull impeller from the motor and rinse properly. Use an *Aqua One* double ended pipe brush to clean the impeller and the impeller well and also any of the outlet options that are being used.

5. Put the power head back together and return to the aquarium. Ensure your hand is not wet, plug in at the power supply and turn on.

Aqua One Power Head Range Specifications

Aqua One 300 Series Mini Low Voltage Power Heads 12V-AC, 50Hz

Mode	L/Hr	Dimensions HxWxD	Watt	Max Head	Outlet
300-LV	150	12.5 x 3.5 x 3cm	2.5	0.38m	9mm
301-LV	250	13 x 4 x 3 cm	3.5	0.50m	9 + 13mm
302-LV	450	14 x 4.5 x 5.5cm	6.5	0.70m	9 + 13mm
302-ML*	450	14 x 4.5 x 5.5cm	6.5	0.70m	9 + 13mm

Aqua One 100 Series Maxi Power Heads 12V-AC, 50H

Mode	L/Hr	Dimensions HxWxD	Watt	Max Head	Outlet
101	400	16 x 4.5 x 7 cm	6	0.65m	9 + 13mm
102	500	23 x 4.5 x 8.5cm	8	1.05m	9 + 13mm
103	1200	28.5 x 6 x 8cm	15	1.2m	16mm
104	2000	33.5 x 7 x 9cm	30	2.0m	19mm
105	2500	28.5 x 6 x 8cm	45	2.5m	19mm
106	3000	33.5 x 7 x 9cm	80	3.5m	19mm



Aqua One 100 Series Power Heads Shown Above 105/102/101

Aqua One Internal Filter Range Specifications

Aqua One 300 Series Mini Low Voltage Internal Filters 12V-AC, 50Hz			
Model	L/Hr	Dimensions HxWxD	Watt
300F-LV	150	12.5 x 3.5 x 3cm	2.5
301F-LV	250	13 x 4 x 3 cm	3.5
302F-LV	450	14 x 4.5 x 5.5cm	6.5
Aqua One 100 Series Maxi Internal Filters 12V-AC, 50Hz			
Model	L/Hr	Dimensions HxWxD	Watt
101F	400	16 x 4.5 x 7 cm	6
102F	500	23 x 4.5 x 8.5cm	8
103F	1200	28.5 x 6 x 8cm	15
104F	2000	33.5 x 7 x 9cm	30



Aqua One 300 Series Mini Low Volgage Shown Abobe 300/301/302-LV

Aqua One - 2 + 1 Year Guarantee

Congratulations on your purchase of a quality Aqua One product. This product will last for many years under normal usage the guarantee commences from the day of purchase. You must provide proof of purchase when you submit your equipment for repair under guarantee.

The benefits given to the purchaser by the manufacturers guarantee are in addition to all other rights and remedies which the purchaser has in respect of the equipment under the legislation of the appropriate country of purchase.

Your 2 year guarantee can be extended by a further 1 year upon registration with the distributor. This can be done online at the address below or by completing the extended guarantee registration card and returning by post to the address of your country of purchase.

www.aquaone.com.au

General Guarantee Conditions:

1. All claims for guarantee service should be made to the place of purchase.
2. You must provide proof of purchase when you submit your equipment for repair under guarantee.
3. This guarantee extends only to defects occurring in materials or workmanship under normal use of the equipment when operated in accordance with the supplied instructions.
4. Replacement equipment is guaranteed for the remainder of the original manufacturer's guarantee period.
5. Guarantee does not cover:
 - a. Cost of freight, postage or the cost of insurance.
 - b. Service costs arising from failure to correctly adjust the controls of the product or to clean the hoses, filter media, impellers, pump heads, failure to observe the manufacturer's instructions or inspections that reveal that the equipment is in normal working order.
 - c. Equipment failures caused by misuse, neglect, normal wear and tear, accidental breakage, repairs or modification by unauthorised persons, lightning strikes, mains voltage fluctuation, earthquakes, vermin infestation or liquid spillage.
 - d. Consumables, such as impellers, shafts, filter cartridges, filter media, sponges or wool.
 - e. In no event will the manufacturer or distributor of that country be liable for any consequential or incidental damage including, but not limited to loss of livestock, property damage, damage to equipment, appliances or furnishings arising from the use of this product or from failure of this product.
 - f. Damaged incurred in transit resulting from inadequate packing.
6. It is recommended that all equipment subject to claim should be prepared for transportation in its original packaging or other suitable packaging which offers the same degree of protection.